

Ceiling Fan

expella™

High performance header box fan

1HB1501

The Expella Ceiling Fan has a unique slimline cover plate and is capable of exhausting up to 270 cubic meters of air per hour.

With integrated fixing lugs, this light weight fan is easy to install and is a cost effective bathroom ventilation solution for most residential and light commercial exhaust applications.



Manufacturer:

expella™

Warranty:

2 years

Applications and Installation:

- Ceiling mounted
- To be used in conjunction with an external grille and flexible or rigid ducting (not included)
- Suitable for single room applications including:
 - Bathrooms
 - Laundries
 - Garbage exhaust
- Can be installed by a home handyman or industry professional (electrician or air conditioning installer)

Features and Benefits:

- Slimline face plate for a discreet look
- Easy to clean and maintain
- A wider fan blade with increased blade angle ensures higher air flow and quiet operation
- Centrifugal motor ensures high performance when connected to long lengths of ducting
- Integrated non-return damper that prevents air coming back through the fan when it is switched off
- Comes with integrated fixing lugs to simplify installation
- Light weight fan housing which simplifies installation (no need for an additional support frame)
- Comes with a 3 pin plug and lead making installation easy

Ceiling Fan

High performance header box fan

Applications:

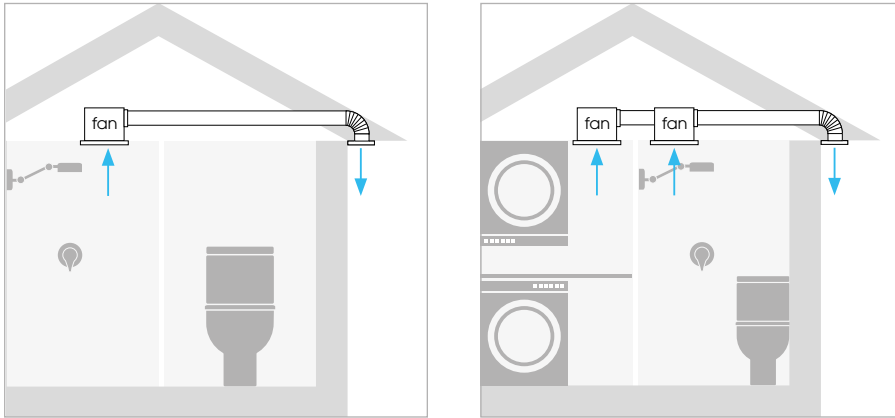

Specifications:

Model	Item Code	Duct size (mm)	Volts	Power (W)	Volume m ³ /h	Volume L/s	Pressure (maximum)	Noise dB(A)	Weight (kg)	IP Rating
HB1501	1HB1501	150	220-240 VAC 50Hz	34	270	75	110	45	2.5	IPX4*

* IPX4 rating applies only for water ingress from fan intake when mounted to a ceiling only

Dimensions:

Model	A	B	C	D	E	F
HB1501	310	290	56	124	274	315

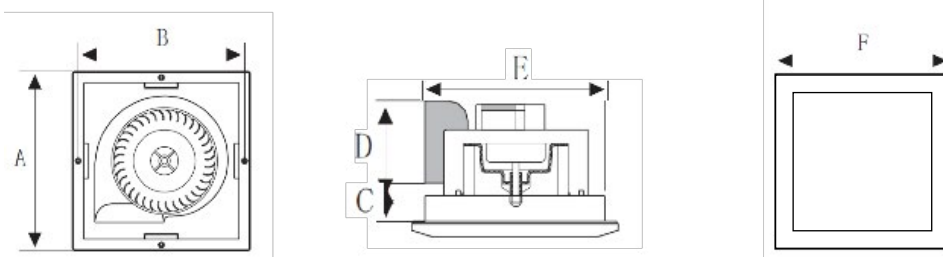

Performance:

