

## High performance inline fans

2AX1102 | 2AX1103 | 2AX1222 | 2AX1223 | 2AX1568 | 2AX1569  
2AX1672 | 2AX1688 | 2AX2098 | 2AX2561 | 2AX3105 | 2AX3559

The AXC Metal inline fan range is available in 8 sizes and is suitable for ducted systems in commercial, industrial, and large residential applications.

With their high-performance centrifugal motors, the AXC Metal range moves large volumes of air working with up to 20m of ducting – perfect for servicing multiple rooms.



### Manufacturer:



### Warranty:

2 years

### Applications and Installation:

- To be used in conjunction with internal grilles and ducting (not included)
- Works with long ducting lengths (up to 20m)\*
- Suitable for multiple room applications including:
  - Bathrooms
  - Laundries
  - Kitchens and rangehoods
  - Garbage exhaust
  - Supply air systems
- It is recommended that this product be installed by an industry professional (electrician or air-conditioning installer)

\*Correctly sized ducting

### Features and Benefits:

- Backward curved blades to ensure quiet operation and develop ample static pressure
- Ideal solution for centralised / multi-point ventilation systems
- Ideal for moving medium to large air volumes against higher static resistance
- Can be used with long lengths of rigid or flexible ducting
- Heavy gauge, spun steel housing with baked epoxy finish
- Ball bearing motor, permanently lubricated for maintenance free operation and continuous running
- Available in 8 sizes
- European made
- ErP (European Eco-Design) compliant

# AXC Metal

## High performance inline fans

### Applications:

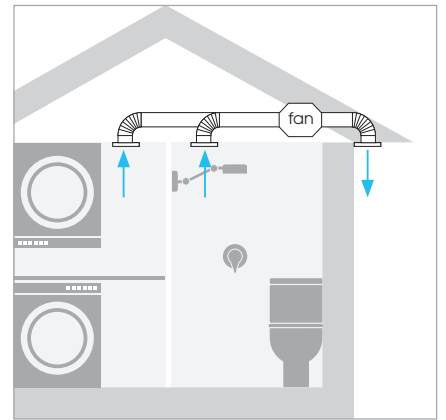
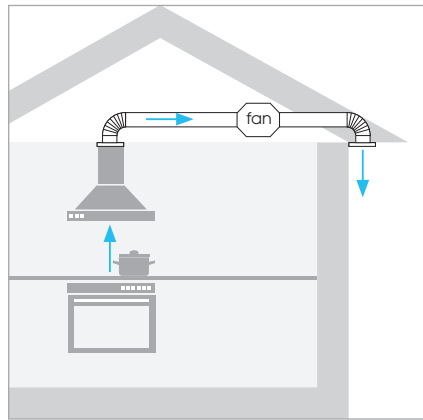
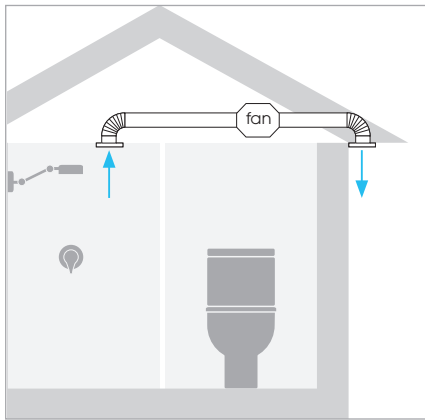

### Specifications:

Model	Item Code	Duct size (mm)	Volume m <sup>3</sup> /h (maximum)	Volume L/s (maximum)	Pressure (maximum)	Wattage	Amps	Noise dB(A)*	RPM
AXC 100 A	2AX1102	100	237	66	279	27	0.13	30	1990
AXC 100 B	2AX1103	100	260	72	383	50	0.23	36	2530
AXC 125 A	2AX1222	125	287	80	238	27	0.13	32	1700
AXC 125 B	2AX1223	125	313	87	345	50	0.23	36	2400
AXC 150 A	2AX1568	150	337	94	189	29	0.14	33	2470
AXC 150 B	2AX1569	150	537	149	406	80	0.37	39	2450
AXC 160 A	2AX1672	160	365	101	203	29	0.14	31	2395
AXC 160 B	2AX1688	160	754	209	476	110	0.50	38	2550
AXC 200	2AX2098	200	887	245	460	110	0.50	34	2450
AXC 250	2AX2561	250	1114	309	543	150	0.85	43	2550
AXC 315	2AX3105	315	1439	400	749	260	1.14	43	2645
AXC 355 B	2AX3559	355	2350	653	902	650	2.82	77	2560

\* Measured at 3 metres

### Dimensions:

Model Item	A	B	C	ØD	Ød	E	Kg
AXC 100 A & B	12	215	24	245	98	38	3
AXC 125 A & B	11	214	24	245	122	38	3
AXC 150 A	21	216	23	245	147	38	3
AXC 150 B	22	230	22	333	148	38	5
AXC 160 A	24	215	24	245	157	38	3
AXC 160 B	21	230	22	333	158	38	5
AXC 200	22	230	27	333	198	38	5
AXC 250	22	230	35	333	248	38	5
AXC 315	30	308	52	404	314	38	9
AXC 355	44	400	50	484	355	38	14

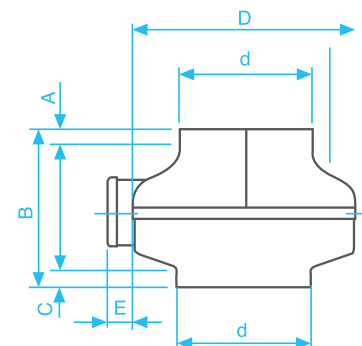

# AXC Metal

## High performance inline fans

### Performance:

